

# FSA INFO PACKET



A DIVISION OF WHITETAIL  
PROPERTIES REAL ESTATE, LLC

[RANCHANDFARMAUCTIONS.COM](http://RANCHANDFARMAUCTIONS.COM)

ILLINOIS  
 HENDERSON  
 Form: FSA-156EZ



Abbreviated 156 Farm Record

FARM : 4020  
 Prepared : 11/17/25 9:43 AM CST  
 Crop Year : 2026

State Conservation	Other Conservation	Effective DCP Cropland	Double Cropped	CRP	MPL	DCP Ag. Rel Activity	SOD
0.00	0.00		0.00	0.00	0.00	0.00	0.00

DCP Crop Data

Crop Name	Base Acres	CCC-505 CRP Reduction Acres	PLC Yield
		0.00	
		0.00	
		0.00	
<b>TOTAL</b>		<b>0.00</b>	

NOTES

\* Tract Number : 12105  
 Description : K11-1 SEC 33 BIGGSVILLE TWP  
 FSA Physical Location : ILLINOIS/HENDERSON  
 ANSI Physical Location : ILLINOIS/HENDERSON  
 BIA Unit Range Number :  
 HEL Status : NHEL: No agricultural commodity planted on undetermined fields  
 Wetland Status : Wetland determinations not complete  
 WL Violations : None  
 Owners : FORT FAMILY FARM PARTNERSHIP  
 Other Producers : None  
 Recon ID : None

Tract Land Data

Farm Land	Cropland	DCP Cropland	WBP	EWP	WRP	GRP	Sugarcane
76.39	76.39	76.39	0.00	0.00	0.00	0.00	0.0
State Conservation	Other Conservation	Effective DCP Cropland	Double Cropped	CRP	MPL	DCP Ag. Rel Activity	SOD
0.00	0.00	76.39	0.00	0.00	0.00	0.00	0.00





DCP Crop Data

Crop Name	Base Acres	CCC-505 CRP Reduction Acres	PLC Yield
Corn	57.40	0.00	191
Soybeans	18.99	0.00	51
<b>TOTAL</b>	<b>76.39</b>	<b>0.00</b>	



NOTES



**Legend**

-  Tract Boundary
-  Non-Cropland
-  Cropland
-  CRP

**Wetland Determination Identifiers**

-  Restricted Use
-  Limited Restrictions
-  Exempt from Conservation Compliance Provisions

**2025 Program Year**

Map Created March 12, 2025

**Farm 4020**  
**Tract 12105**

**Tract Cropland Total: 76.39 acres**

IL071\_T12105

United States Department of Agriculture (USDA) Farm Service Agency (FSA) maps are for FSA Program administration only. This map does not represent a legal survey or reflect actual ownership; rather it depicts the information provided directly from the producer and/or National Agricultural Imagery Program (NAIP) imagery. The producer accepts the data 'as is' and assumes all risks associated with its use. USDA-FSA assumes no responsibility for actual or consequential damage incurred as a result of any user's reliance on this data outside FSA Programs. Wetland identifiers do not represent the size, shape, or specific determination of the area. Refer to your original determination (CPA-026 and attached maps) for exact boundaries and determinations or contact USDA Natural Resources Conservation Service (NRCS).

# Aerial Map



Boundary Center: 40.812301, -90.850566



WHITETAIL PROPERTIES REAL ESTATE  
HUNTING | RANCH | FARM | TIMBER

Maps Provided By:



© AgriData, Inc. 2023 www.AgriDataInc.com

**33-10N-4W**  
**Henderson County**  
**Illinois**



10/13/2025

Field borders provided by Farm Service Agency as of 5/21/2008.

# Soils Map

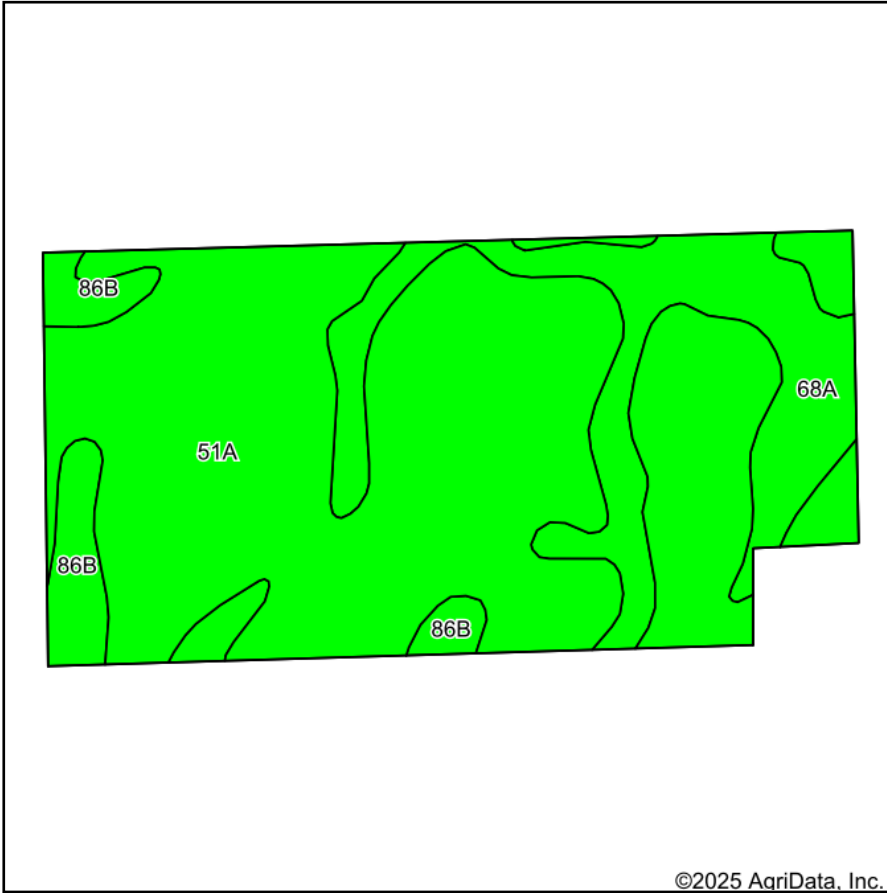

Soils data provided by USDA and NRCS.

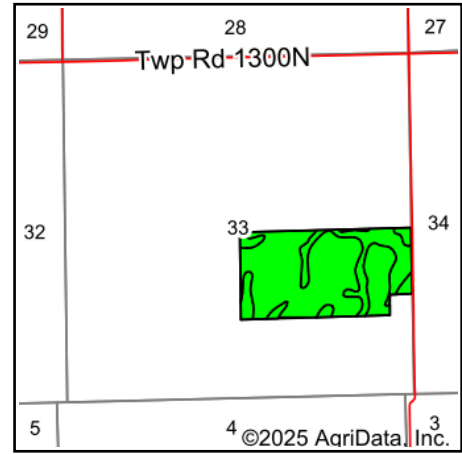

State: **Illinois**  
 County: **Henderson**  
 Location: **33-10N-4W**  
 Township: **Biggsville**  
 Acres: **76.39**  
 Date: **10/13/2025**



WHITETAIL PROPERTIES REAL ESTATE  
 HUNTING | RANCH | FARM | TIMBER

Maps Provided By:



Area Symbol: IL071, Soil Area Version: 26

Code	Soil Description	Acres	Percent of field	Il. State Productivity Index Legend	Corn Bu/A	Soybeans Bu/A	Crop productivity index for optimum management	*n NCCPI Overall	*n NCCPI Corn	*n NCCPI Small Grains	*n NCCPI Soybeans
51A	Muscataune silt loam, 0 to 2 percent slopes	56.40	73.9%		200	64	147	95	95	80	79
**68A	Sable silty clay loam, 0 to 2 percent slopes	14.47	18.9%		**192	**63	**143	84	84	70	75
**86B	Oscos silt loam, 2 to 5 percent slopes	5.52	7.2%		**187	**59	**138	92	92	76	78
<b>Weighted Average</b>					<b>197.5</b>	<b>63.4</b>	<b>145.6</b>	<b>*n 92.7</b>	<b>*n 92.7</b>	<b>*n 77.8</b>	<b>*n 78.2</b>

**Table: Optimum Crop Productivity Ratings for Illinois Soil EFOTG are sourced from Bulletin 811 calculated Map Unit Base Yield Indices, and adjusted (Adj) for slope, erosion, flooding, and surface texture.** Publication Date: 01-28-2025

Crop yields and productivity (B811 EFOTG) are maintained at the following USDA web site: 2023 Illinois Soil Productivity and Yield Indices: <https://efotg.sc.egov.usda.gov/#/state/IL/documents/section=2&folder=52809>

\*\* Base indexes from Bulletin 811 adjusted for slope, erosion, flooding, and surface texture according to the Il. Soils EFOTG

\*n: The aggregation method is "Weighted Average using all components"

# Topography Hillshade

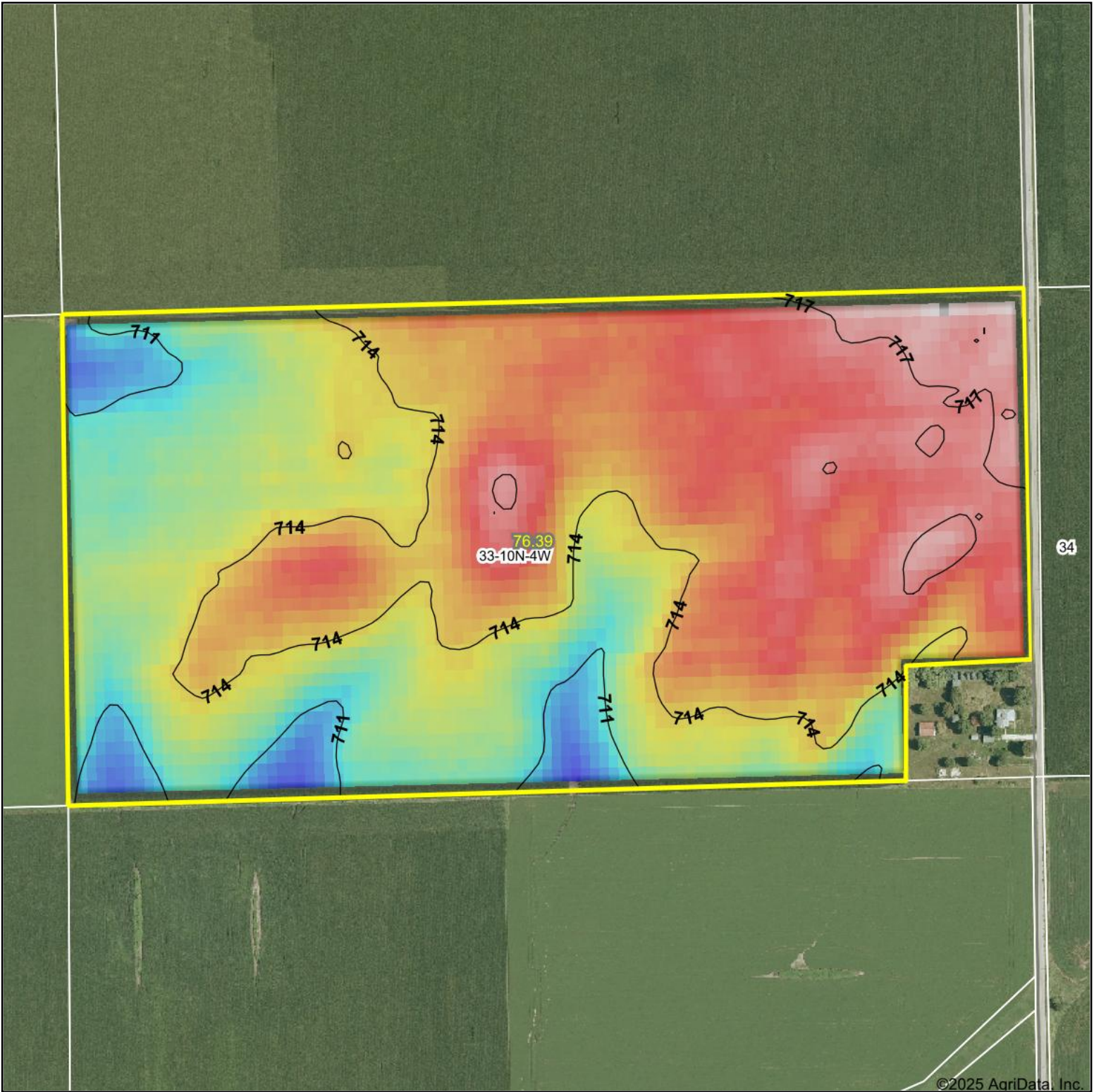

©2025 AgriData, Inc.

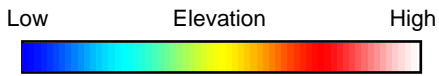

Source: USGS 10 meter dem  
 Interval(ft): 3  
 Min: 708.8  
 Max: 718.5  
 Range: 9.7  
 Average: 714.2  
 Standard Deviation: 1.9 ft

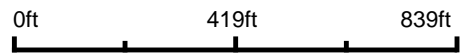

**33-10N-4W**  
**Henderson County**  
**Illinois**

Boundary Center: 40.812301, -90.850566



Maps Provided By:



© AgriData, Inc. 2023 www.AgriDataInc.com

Field borders provided by Farm Service Agency as of 5/21/2008.