

# FSA INFO PACKET



A DIVISION OF WHITETAIL  
PROPERTIES REAL ESTATE, LLC

[RANCHANDFARMAUCTIONS.COM](http://RANCHANDFARMAUCTIONS.COM)



[REDACTED]  
[REDACTED]  
[REDACTED]  
[REDACTED]  
[REDACTED]

[REDACTED]									
[REDACTED]	[REDACTED]	[REDACTED]	[REDACTED]	[REDACTED]	[REDACTED]	[REDACTED]	[REDACTED]	[REDACTED]	[REDACTED]
[REDACTED]	[REDACTED]	[REDACTED]	[REDACTED]	[REDACTED]	[REDACTED]	[REDACTED]	[REDACTED]	[REDACTED]	[REDACTED]
[REDACTED]	[REDACTED]	[REDACTED]	[REDACTED]	[REDACTED]	[REDACTED]	[REDACTED]	[REDACTED]	[REDACTED]	[REDACTED]
[REDACTED]	[REDACTED]	[REDACTED]	[REDACTED]	[REDACTED]	[REDACTED]	[REDACTED]	[REDACTED]	[REDACTED]	[REDACTED]

[REDACTED]		
[REDACTED]	[REDACTED]	[REDACTED]
[REDACTED]	[REDACTED]	[REDACTED]

[REDACTED]				
[REDACTED]	[REDACTED]	[REDACTED]	[REDACTED]	[REDACTED]
[REDACTED]	[REDACTED]	[REDACTED]	[REDACTED]	[REDACTED]
[REDACTED]	[REDACTED]	[REDACTED]	[REDACTED]	[REDACTED]

[REDACTED] S
[REDACTED]

**Tract Number** : 2146

**Description** : N2 NE4, PT N2 NW4 SEC 8 REMSEN

**FSA Physical Location** : IOWA/PLYMOUTH

**ANSI Physical Location** : IOWA/PLYMOUTH

**BIA Unit Range Number** :

**HEL Status** : HEL field on tract.Conservation system being actively applied

**Wetland Status** : Tract does not contain a wetland

**WL Violations** : None

**Owners** : BZB FAMILY FARMS LLC

**Other Producers** : None

**Recon ID** : None

Tract Land Data							
Farm Land	Cropland	DCP Cropland	WBP	EWP	WRP	GRP	Sugarcane
133.23	128.16	128.16	0.00	0.00	0.00	0.00	0.0

IOWA  
PLYMOUTH  
Form: FSA-156EZ



United States Department of Agriculture  
Farm Service Agency

**FARM : 10057**  
Prepared : 1/29/25 9:47 AM CST  
Crop Year : 2025

**Abbreviated 156 Farm Record**

**Tract 2146 Continued ...**

State Conservation	Other Conservation	Effective DCP Cropland	Double Cropped	CRP	MPL	DCP Ag. Rel Activity	SOD
0.00	0.00	126.76	0.00	1.40	0.00	0.00	0.00

**DCP Crop Data**

Crop Name	Base Acres	CCC-505 CRP Reduction Acres	PLC Yield
Corn	67.65	0.00	169
Soybeans	59.10	1.40	42
<b>TOTAL</b>	<b>126.75</b>	<b>1.40</b>	

**NOTES**

--



- Legend**
- Non-Cropland
  - CRP
  - Iowa PLSS
  - Tract Boundary
  - Iowa Roads

- Wetland Determination Identifiers**
- Restricted Use
  - ▼ Limited Restrictions
  - Exempt from Conservation Compliance Provisions

**Producers/Shares**

---



---

**Irrigation**

X NI

IR

**Intended Use**

Grain

Forage

Grazed

**2024 Program Year**  
Map Created May 10, 2024

**Tract Cropland Total: 128.16 acres**

**Farm 10057**  
**Tract 2146**

**"Options only for certification maps & valid only if filled in"**

United States Department of Agriculture (USDA) Farm Service Agency (FSA) maps are for FSA Program administration only. This map does not represent a legal survey or reflect actual ownership; rather it depicts the information provided directly from the producer and/or National Agricultural Imagery Program (NAIP) imagery. The producer accepts the data 'as is' and assumes all risks associated with its use. USDA-FSA assumes no responsibility for actual or consequential damage incurred as a result of any user's reliance on this data outside FSA Programs. Wetland identifiers do not represent the size, shape, or specific determination of the area. Refer to your original determination (CPA-026 and attached maps) for exact boundaries and determinations or contact USDA Natural Resources Conservation Service (NRCS).

USDA is an equal opportunity provider, employer, and lender.



<b>CRP-1</b> (01-08-24)  <b>U.S. DEPARTMENT OF AGRICULTURE</b> Commodity Credit Corporation  <b>CONSERVATION RESERVE PROGRAM CONTRACT</b>	1. ST. & CO. CODE & ADMIN. LOCATION 19 149	2. SIGN-UP NUMBER 47
	3. CONTRACT NUMBER 11144C	4. ACRES FOR ENROLLMENT 1.40

5A. COUNTY FSA OFFICE ADDRESS (Include Zip Code) PLYMOUTH COUNTY FARM SERVICE AGENCY 1100 12TH ST SW, SUITE B LE MARS, IA51031-3034	6. TRACT NUMBER 2146	7. CONTRACT PERIOD FROM: (MM-DD-YYYY) TO: (MM-DD-YYYY) 10-01-2015 09-30-2025	
5B. COUNTY FSA OFFICE PHONE NUMBER (Include Area Code): (712) 546-4178	8. SIGNUP TYPE: Continuous		

**THIS CONTRACT is entered into between the Commodity Credit Corporation (referred to as "CCC") and the undersigned owners, operators, or tenants (referred to as "the Participant"). The Participant agrees to place the designated acreage into the Conservation Reserve Program ("CRP") or other use set by CCC for the stipulated contract period from the date the Contract is executed by the CCC. The Participant also agrees to implement on such designated acreage the Conservation Plan developed for such acreage and approved by the CCC and the Participant. Additionally, the Participant and CCC agree to comply with the terms and conditions contained in this Contract, including the Appendix to this Contract, entitled Appendix to CRP-1, Conservation Reserve Program Contract (referred to as "Appendix"). By signing below, the Participant acknowledges receipt of a copy of the Appendix/Appendices for the applicable contract period. The terms and conditions of this contract are contained in this Form CRP-1 and in the CRP-1 Appendix and any addendum thereto. BY SIGNING THIS CONTRACT PARTICIPANTS ACKNOWLEDGE RECEIPT OF THE FOLLOWING FORMS: CRP-1; CRP-1 Appendix and any addendum thereto; and, CRP-2, CRP-2C, CRP-2G, or CRP-2C30, as applicable.**

9A. Rental Rate Per Acre	\$ 409.64	10. Identification of CRP Land (See Page 2 for additional space)				
9B. Annual Contract Payment	\$ 573.00	A. Tract No.	B. Field No.	C. Practice No.	D. Acres	E. Total Estimated Cost-Share
9C. First Year Payment	\$	2146	3	CP8A	1.40	\$ 176.00
<i>(Item 9C is applicable only when the first year payment is prorated.)</i>						

**11. PARTICIPANTS (If more than three individuals are signing, see Page 3.)**

A(1) PARTICIPANT'S NAME AND ADDRESS (Include Zip Code)	(2) SHARE	(3) SIGNATURE (By)	(4) TITLE/RELATIONSHIP OF THE INDIVIDUAL SIGNING IN THE REPRESENTATIVE CAPACITY	(5) DATE (MM-DD-YYYY)
JJP FARMS INC C/O JEFF POTTBAUM 41704 HIGHWAY 3 REMSEN, IA51050-8503	100.00 %			
B2B FAMILY FARMS LLC C/O EMILY ZUBAID 1590 OTTER LN NORTH LIBERTY, IA52317-8100	0.00 %			
C(1) PARTICIPANT'S NAME AND ADDRESS (Include Zip Code)	%			

<b>12. CCC USE ONLY</b>	A. SIGNATURE OF CCC REPRESENTATIVE	B. DATE (MM-DD-YYYY)
-------------------------	------------------------------------	----------------------

**NOTE:** The following statement is made in accordance with the Privacy Act of 1974 (5 USC 552a - as amended). The authority for requesting the information identified on this form is the Commodity Credit Corporation Charter Act (15 U.S.C. 714 et seq.), the Food Security Act of 1985 (16 U.S.C. 3801 et seq.), the Agricultural Act of 2014 (16 U.S.C. 3831 et seq), the Agricultural Improvement Act of 2018 (Pub. L. 115-334), the Further Continuing Appropriations and Other Extensions Act, 2024 (Pub. L. 118-22), and the Conservation Reserve Program 7 CFR Part 1410. The information will be used to determine eligibility to participate in and receive benefits under the Conservation Reserve Program. The information collected on this form may be disclosed to other Federal, State, Local government agencies, Tribal agencies, and nongovernmental entities that have been authorized access to the information by statute or regulation and/or as described in applicable Routine Uses identified in the System of Records Notice for USDA/FSA-2, Farm Records File (Automated). Providing the requested information is voluntary. However, failure to furnish the requested information will result in a determination of ineligibility to participate in and receive benefits under the Conservation Reserve Program.

**Paperwork Reduction Act (PRA) Statement:** The information collection is exempted from PRA as specified in 16 U.S.C. 3846(b)(1). The provisions of appropriate criminal and civil fraud, privacy, and other statutes may be applicable to the information provided. **RETURN THIS COMPLETED FORM TO YOUR COUNTY FSA OFFICE.**

In accordance with Federal civil rights law and U.S. Department of Agriculture (USDA) civil rights regulations and policies, the USDA, its Agencies, offices, and employees, and institutions participating in or administering USDA programs are prohibited from discriminating based on race, color, national origin, religion, sex, gender identity (including gender expression), sexual orientation, disability, age, marital status, family/parental status, income derived from a public assistance program, political beliefs, or reprisal or retaliation for prior civil rights activity, in any program or activity conducted or funded by USDA (not all bases apply to all programs). Remedies and complaint filing deadlines vary by program or incident.

Persons with disabilities who require alternative means of communication for program information (e.g., Braille, large print, audiotape, American Sign Language, etc.) should contact the responsible Agency or USDA's TARGET Center at (202) 720-2600 (voice and TTY) or contact USDA through the Federal Relay Service at (800) 877-8339. Additionally, program information may be made available in languages other than English.

To file a program discrimination complaint, complete the USDA Program Discrimination Complaint Form, AD-3027, found online at [http://www.ascr.usda.gov/complaint\\_filing\\_cust.html](http://www.ascr.usda.gov/complaint_filing_cust.html) and at any USDA office or write a letter addressed to USDA and provide in the letter all of the information requested in the form. To request a copy of the complaint form, call (866) 632-9992. Submit your completed form or letter to USDA by: (1) mail: U.S. Department of Agriculture Office of the Assistant Secretary for Civil Rights 1400 Independence Avenue, SW Washington, D.C. 20250-9410; (2) fax: (202) 690-7442; or (3) email: [program.intake@usda.gov](mailto:program.intake@usda.gov). USDA is an equal opportunity provider, employer, and lender.

# Soils Map

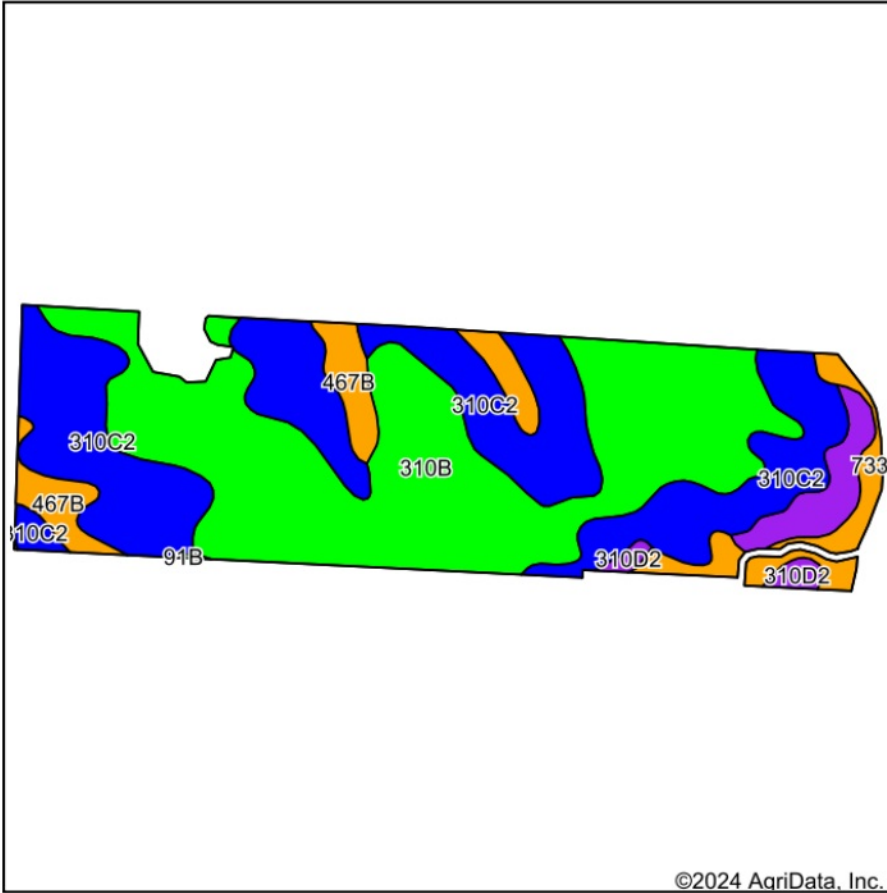

©2024 AgriData, Inc.

Soils data provided by USDA and NRCS.

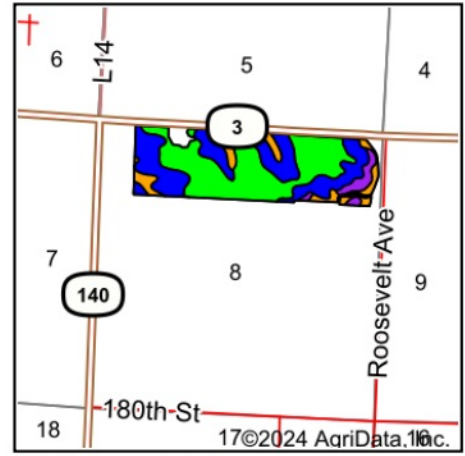

State: Iowa  
 County: Plymouth  
 Location: 8-92N-43W  
 Township: Remsen  
 Acres: 124.34  
 Date: 9/19/2024



WHITETAIL PROPERTIES REAL ESTATE  
 HUNTING | RANCH | FARM | TIMBER

Maps Provided By:



© AgriData, Inc. 2023

www.AgriDataInc.com



Area Symbol: IA149, Soil Area Version: 34

Code	Soil Description	Acres	Percent of field	CSR2 Legend	CSR2**
310B	Galva silty clay loam, 2 to 5 percent slopes	58.18	46.9%		95
310C2	Galva silty clay loam, 5 to 9 percent slopes, eroded	46.95	37.8%		84
467B	Radford silty clay loam, 2 to 5 percent slopes	9.24	7.4%		75
310D2	Galva silty clay loam, 9 to 14 percent slopes, eroded	5.78	4.6%		57
733	Calco silty clay loam, 0 to 2 percent slopes, occasionally flooded	4.13	3.3%		78
91B	Primghar silty clay loam, 2 to 5 percent slopes	0.06	0.0%		95
<b>Weighted Average</b>					<b>87</b>

\*\*IA has updated the CSR values for each county to CSR2.



# Topography Contours



©2024 AgriData, Inc.



WHITETAIL PROPERTIES REAL ESTATE  
HUNTING | RANCH | FARM | TIMBER

Maps Provided By:



© AgriData, Inc. 2023 www.AgriDataInc.com

Field borders provided by Farm Service Agency as of 5/21/2008.

Source: USGS 3 meter dem

Interval(ft): 4.0

Min: 1,374.4

Max: 1,433.7

Range: 59.3

Average: 1,411.9

Standard Deviation: 13.25 ft

0ft 735ft 1471ft



9/19/2024

8-92N-43W  
Plymouth County  
Iowa

Boundary Center: 42.805947, -95.946737